



WORX RACING Yamaha Rear Exhaust Kit

PART # - WR04045

MODELS: Yamaha 2015+ VXR/VXS, FX SVHO

INSTALLATION INSTRUCTIONS

IMPORTANT: READ ALL INSTRUCTIONS BEFORE PROCEEDING WITH INSTALLATION

- 1- Make sure ski is secure and on a flat surface. Remove lanyard and disconnect battery.
- 2- Remove bolts securing seat support to hull. Remove seat support.
- 3- Remove OEM cross over hose from waterbox to sound baffle. Retain OEM clamps.
- 4- Remove sound suppression baffle and hose elbow hose connected to thru hull fitting. Discard baffle. Retain OEM clamp. Remove floatation foam located on top of pump tunnel.
- 5- Disconnect steering cable from steering nozzle, trim rod from nozzle ring, reverse rod from reverse gate, and siphon hose from reduction nozzle.
- 6- Remove pump bracket bolts, and visibility spout hose from reduction nozzle. Remove lower reduction nozzle bolts. Remove reduction nozzle from pump.
- 7- Remove nuts securing stock exhaust outlet to hulls.
- 8- Place block-off in OEM exhaust hole.
- 9- To install outlet, place template on the flattest surface on the right side of the rear of the hull. Please note: For some models outlet may have to go over tow hook position. Retain tow hook and re-drill mounting holes after installation if you wish to retain the tow hook.
NOTE: It is recommended to fit the hose to the waterbox as this stage and mark the center, to ensure hose will line up with planned outlet position.
- 10- Ensure when printing template, scale settings are set to 'none' or 'actual size'.
- 11- Drill pilot hole at centre of intersection. Use 95mm (3 3/4") hole saw to cut out hole for outlet.
- 12- Place outlet in hole with Worx logo positioned at the bottom. Drill out 8 holes to fit bolts. Use marine grade Sikaflex to secure and seal outlet to the hull as the hull is not a perfectly flat surface.
- 13- Place backing plate inside the hull and secure with M6 bolts provided. Do not overtighten bolts as this can cause cracking of the gel coat.
- 14- Fit hose from the waterbox to the outlet, secure hose to waterbox and outlet using OEM clamps.
- 15- Reinstall pump, brackets and all connections listed in steps, 2-6.
- 16- Reconnect battery and start ski to ensure everything is running as intended.

Thank you for purchasing **Worx Racing components** products. We firmly believe that **Worx Racing Components** products are among the finest watercraft parts available. A great deal of time and effort has gone into the design and development of this product to ensure that it will perform to the highest standard and that installation is a relatively straight forward and simple procedure. If you have any questions or comments on the performance and/or installation of our products please contact us at the numbers listed on page one or through your local **Worx** dealer.

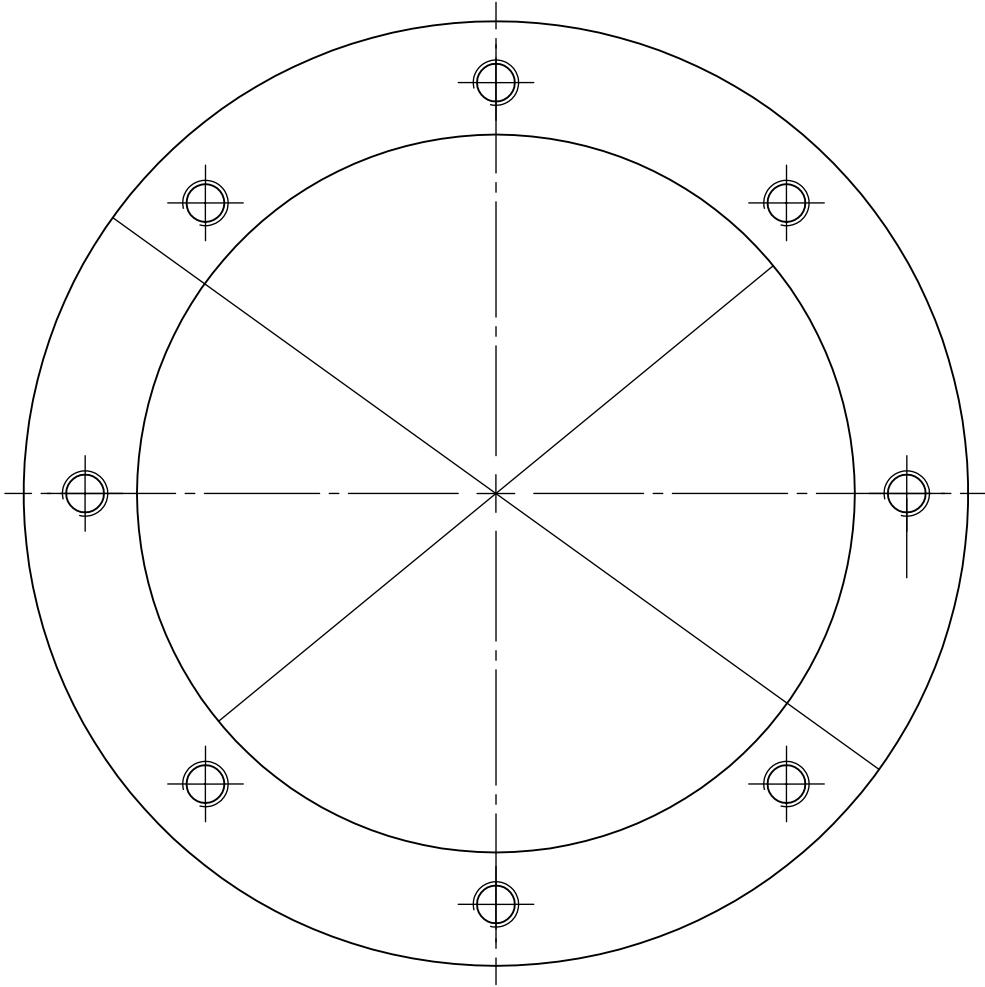

CUTTING TEMPLATE

**ENSURE SCALING IS SET TO 'NONE'
OR 'ACTUAL SIZE' WHEN PRINTING.**